

Route 1A Riverfront Improvement Project

Public Information Meeting

September 26, 2023

Please Sign-In at the front!



HOWARD STEIN HUDSON

Project Team and Presenters

- **City of Revere**
 - Tom Skwierawski, *Chief of Planning and Community Development*
 - Julie DeMauro, *Transportation Coordinator*
- **Howard Stein Hudson**
 - Pete Wroblewski, P.E., *Senior Civil Engineer, Consultant*
- **Spanish Interpretation**
 - Milena Cuadra Seas (Revere TV)
 - Susana Carella (in-person)



Spanish Interpretation - Interpretación al español

- The project team has arranged for Spanish language interpretation to be available during this meeting. Please see the interpreter at the back of the room for a headset.
- El equipo del proyecto ha organizado interpretación al español para esta reunión. Por favor, solicite audífonos al intérprete situado al fondo de la sala.



Agenda

- Project Overview
- Riverfront Master Plan
- Project Goals
- Technical Design
- Timelines
- FAQ
- Contact Information
- Questions



HOWARD STEIN HUDSON

Project Overview



HOWARD STEIN HUDSON

Project Overview



HOWARD STEIN HUDSON

Project Overview (cont.)

- **What the meeting is not**
 - A meeting to review Gibson Park plans (more to come in October)
 - A review of nearby mixed-use development
 - A review General Edwards Bridge re-alignment



Riverfront Master Plan



HOWARD STEIN HUDSON

RiverFront Master Plan

- Improve connectivity, environmental resiliency, and public access to RiverFront
- Renovate recreation areas
- Provide opportunities for new development and uses
- Create an iconic gateway into Revere

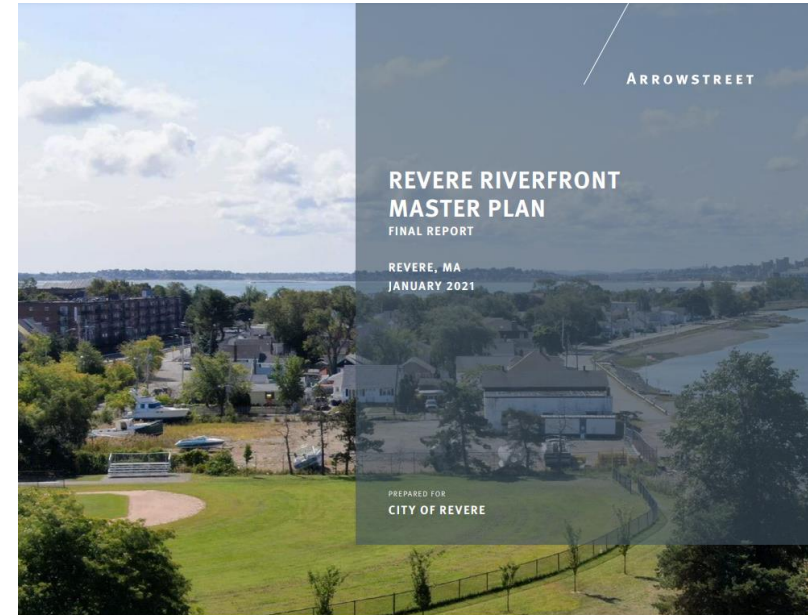

An [online version](#) of the plan is available in the QR code below



HOWARD STEIN HUDSON

RiverFront Master Plan

- Endorsed by Revere City Council in 2021
- Since then:
 - \$15m+ in grants awarded
 - Many more in pipeline
 - Boathouse acquired, designs initiated
 - Roundabout & Gibson Park designs currently in permitting
 - Mixed-use Development under construction



RiverFront Master Plan

- Endorsed by Revere City Council in 2021
- Since then:
 - \$15m+ in grants awarded
 - Many more in pipeline
 - Boathouse acquired, designs initiated
 - Roundabout & Gibson Park designs currently in permitting
 - Mixed-use development under construction



Roundabout Project Goals

- **Key component of Riverfront Master Plan**
 - Connects all other projects
 - Minimizes traffic impact on Riverside and Point of Pines neighborhoods
- **Improve accessibility**
 - Bicycle and pedestrian access to Gibson Park
 - Vehicular access to Gibson Park will immediately follow this project



Project Goals (cont)

- **Improve interchange**
 - Add roundabout intersection
 - Improved 1A NB and SB access to Gibson Park
- **Improve safety**
 - Provide emergency vehicle access
 - Provide safe pedestrian & bicycle access to and from Point of Pines



Technical Design



HOWARD STEIN HUDSON

Technical Design

- **Project constraints**
 - On-ramp length
 - Off-ramp length
 - Elevation
- **Intersection analysis**
 - Roundabout identified as best option with MassDOT
- **Project proponents**
 - Revere
 - MassDOT
- **Traffic Impacts**
 - No added congestion anticipated



Concept Plan (This Project)

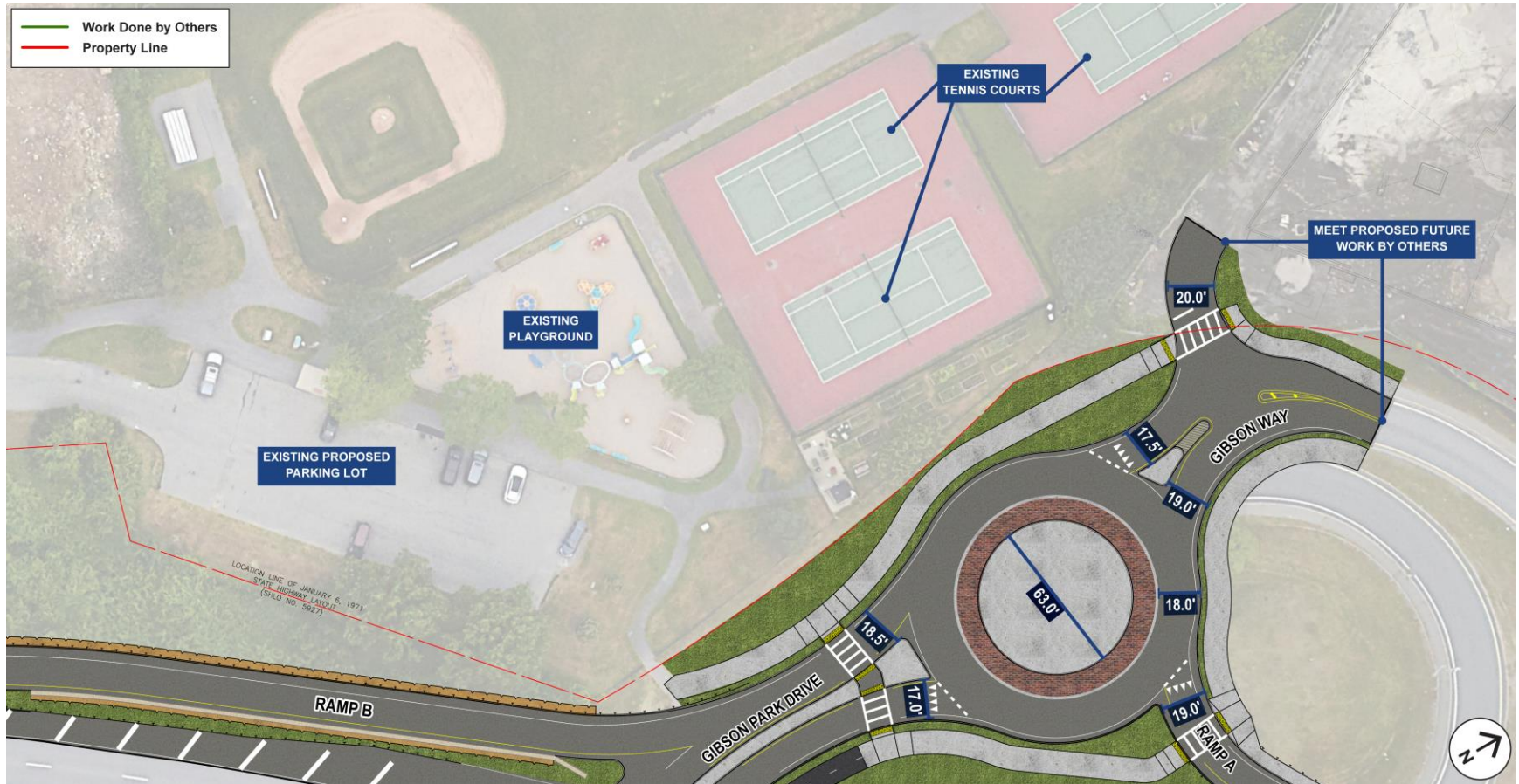

Pedestrian Access (Under Review)

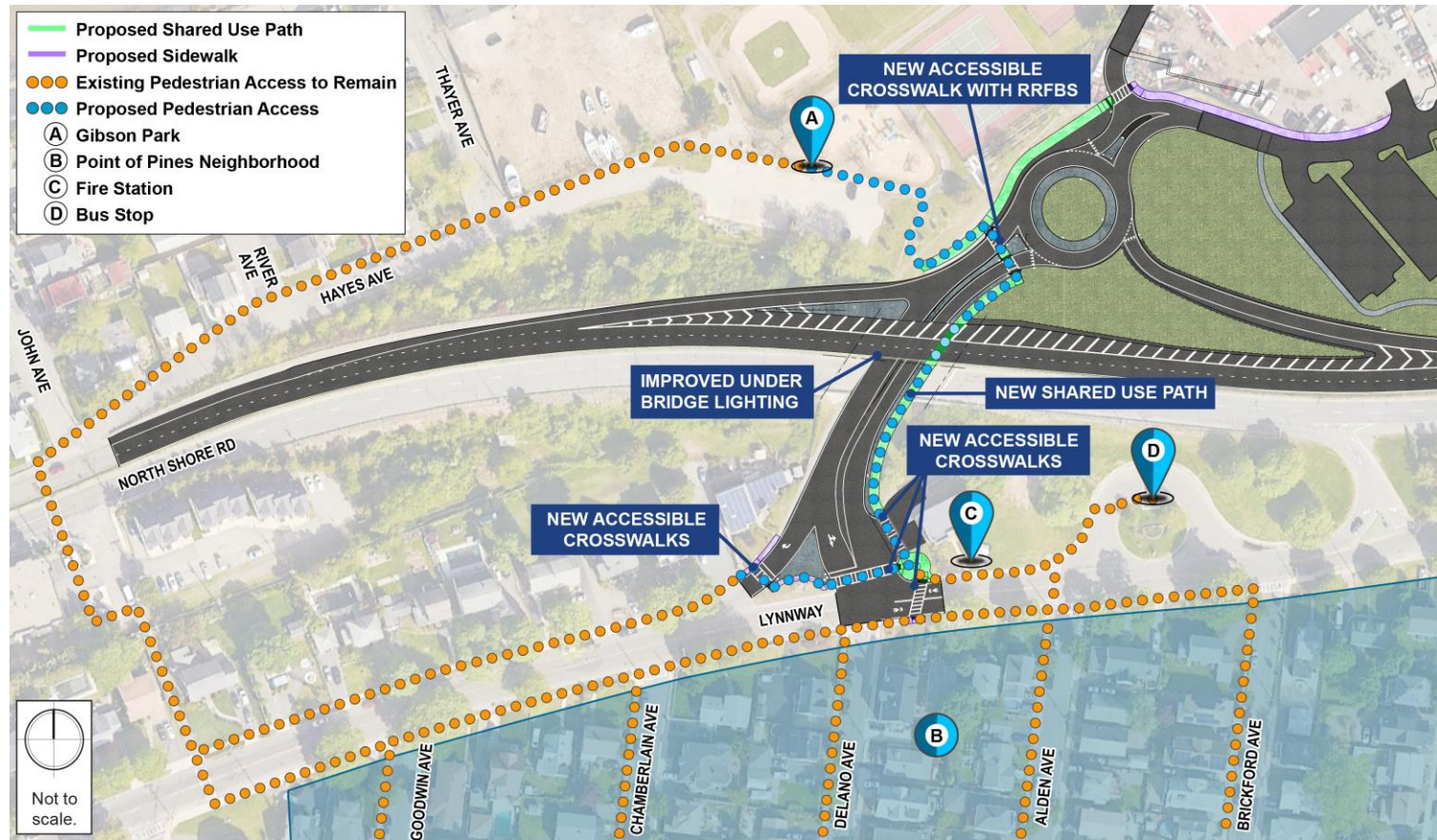

Gibson Park Access (Related Project)

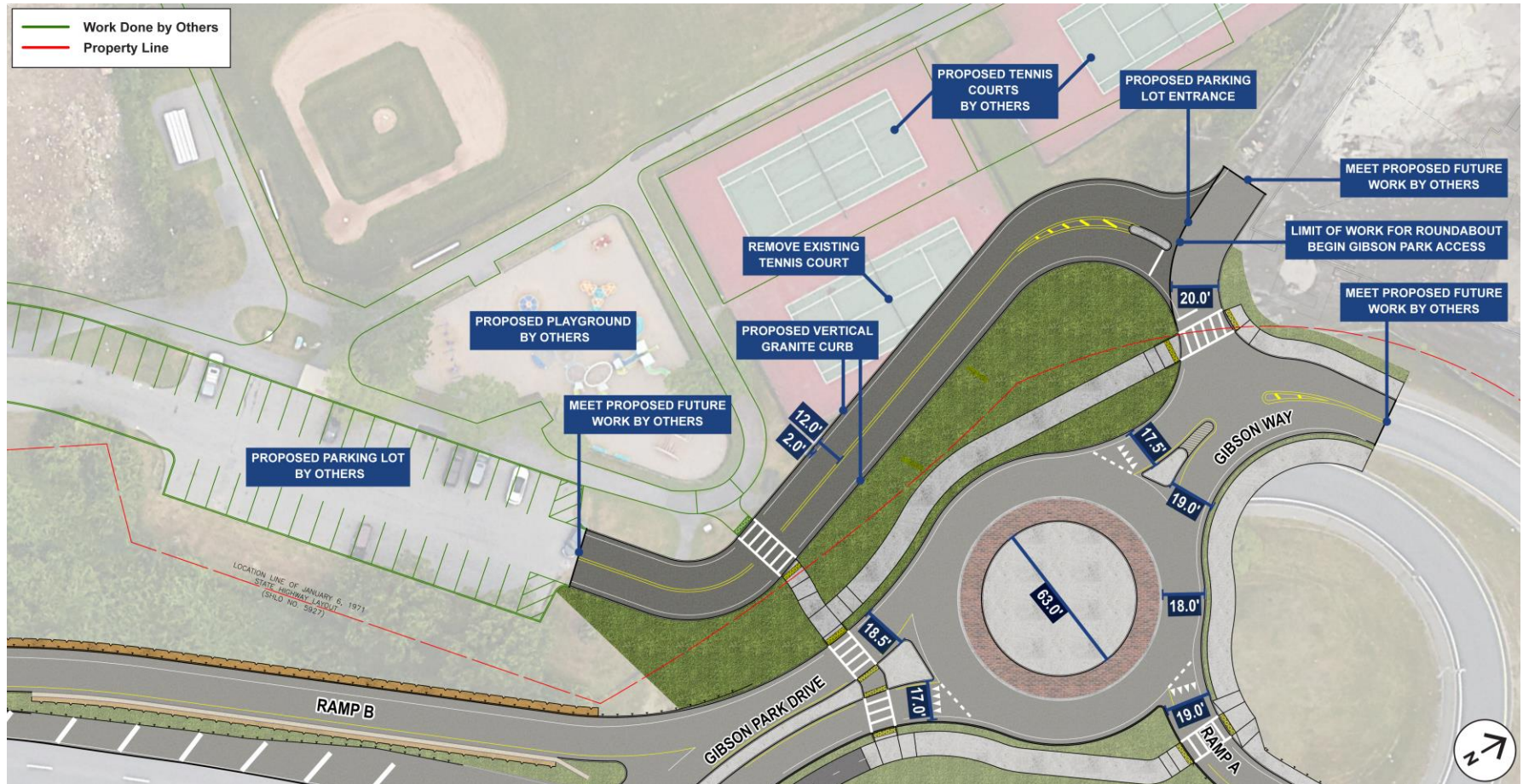

Design Process

25% plans accepted by
Revere and MassDOT

Structural Design
(Geotechnical borings and
wall design)

100% design complete



We are here

Environmental Permitting
(state and federal)



HOWARD STEIN HUDSON

Estimated Project Timeline

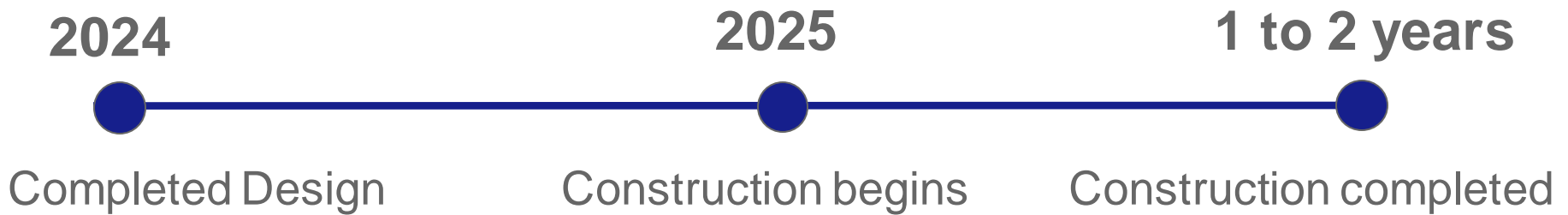

FAQ

- **How can you access the park from Point of Pines?**
 - Bicyclists and pedestrians will have access via a shared use path.
 - Design for the SUP is currently under MassDOT review
 - Vehicle access will be included in subsequent project
- **Why a roundabout?**
 - Reviewed a dozen intersection alternatives with MassDOT and Revere
 - A Roundabout was chosen as the best and only viable option.



FAQ

- **How will vehicles access Gibson Park?**
 - Access will occur through a new driveway entrance to be included in a subsequent project
- **Will there be a meeting to discuss Gibson Park?**
 - Tentatively, a meeting is planned for October 18th @ 6:00 (Venue TBD)
 - Reach out to DPCD for more details



Outreach and Comment Period

- All presentation materials will be available [online](#) under “Projects and Planning Initiatives”
- Public Comment period will run from **Wednesday, September 27 to Wednesday October 11**. All comments should be sent through email to Julie DeMauro at jdemauro@revere.org or through mail at:

Julie DeMauro
Revere City Hall
Department of Planning and Community Development
281 Broadway
Revere, MA 02151



Contact Info

- **City of Revere**
 - Tom Skwierawski
 - *Email: tskwierawski@revere.org*
 - *Phone: [781-286-8181](tel:781-286-8181) ext. 20324*
 - Julie DeMauro
 - *Email: jdemauro@revere.org*
 - *Phone: [781-286-8181](tel:781-286-8181) ext. 20323*



Questions?



HOWARD STEIN HUDSON

Thank You



HOWARD STEIN HUDSON



HOWARD STEIN HUDSON

Emergency Vehicle Access

Current EMS Access Route to 22 Whitin Avenue



Emergency Vehicle Access

Proposed EMS Access Route to 22 Whitin Avenue



Emergency Vehicle Access

Proposed EMS Access Route to 22 Whitin Avenue



Emergency Vehicle Access

Proposed EMS Access Route to 22 Whitin Avenue from Freeman Street Fire Station

→ EMS Access Route to 22 Whitin Avenue
(Fire Truck Total Distance Traveled: 2.0 Miles)

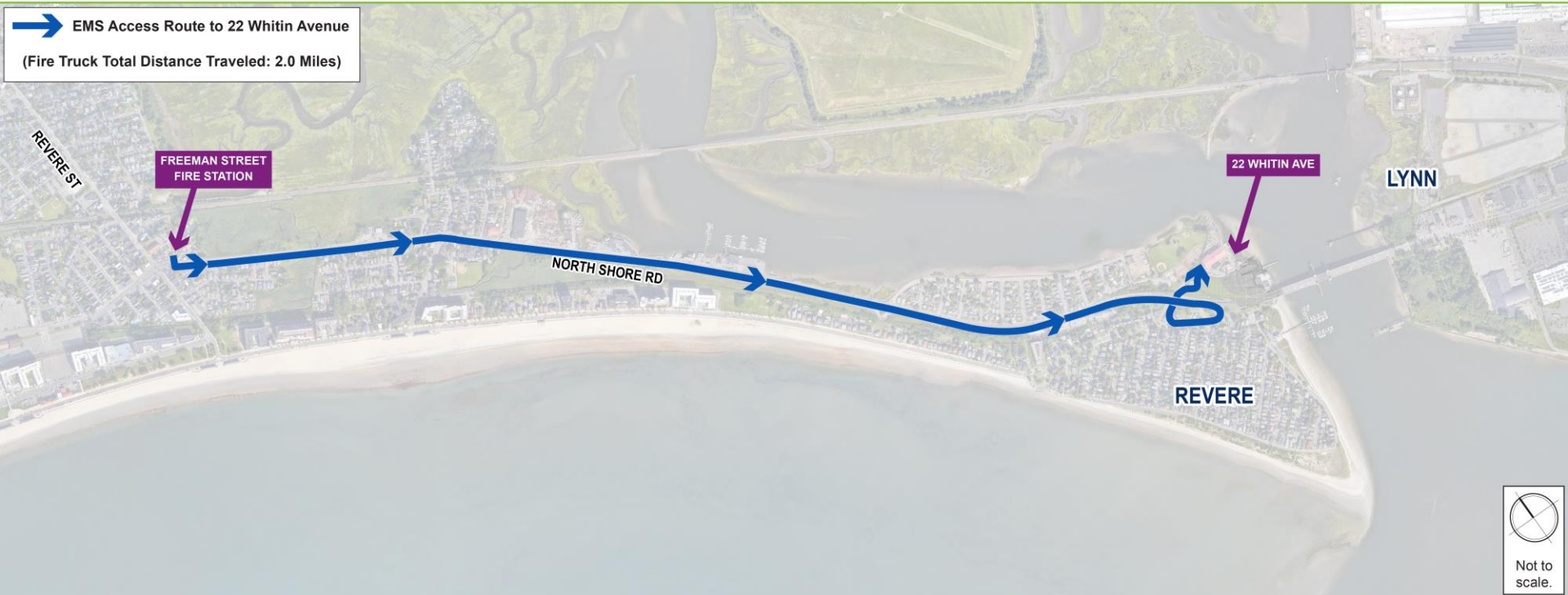

Gibson Point Housing Project



HOWARD STEIN HUDSON

Gibson Park



Gibson Park Boathouse



HOWARD STEIN HUDSON

Gibson Park Boathouse



Gibson Park Boathouse

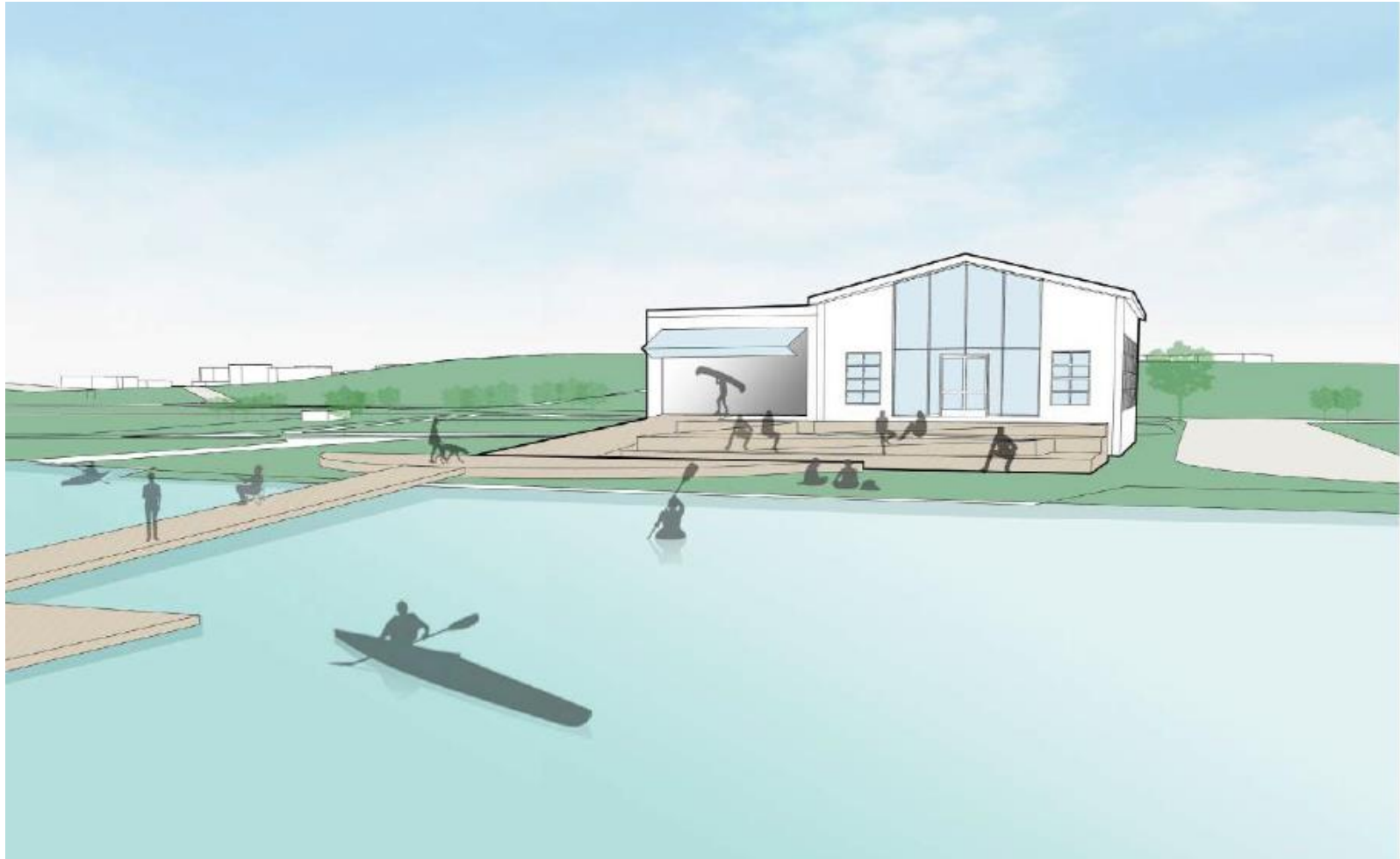

HOWARD STEIN HUDSON